

**REQUEST FOR QUOTATION (RFQ)**

PR/PP No.: 2021-07-414

RFQ No.:

2021-07-717

End-user: RSCC/BGMS

Date:

AUG 02 2021

Name of Project:

ABC:

₱500,000.00

**IMPROVEMENT OF SLOPE PROTECTION AT RSCC PUGUIS, LA TRINIDAD, BENGUET**

**SMALL VALUE PROCUREMENT**

Sir/Madam:

Please quote your lowest price on the item/s described below inclusive of taxes duly signed by you or your authorized representative, subject to the Terms and Condition provided in this RFQ and submit personally to the Office of the Procurement Section, 40 North Drive, Baguio City or through email at [bacsec.car@dswd.gov.ph](mailto:bacsec.car@dswd.gov.ph) on or before **AUG 09 2021** **12:00PM**.

**ENRIQUE H GASCON JR.**  
OIC-ARDA/BAC Chairperson

**TERMS AND CONDITIONS:**

1. Quotations in excess of the ABC will be **REJECTED**.
2. For total quoted price , quotations with a **dash or zero shall be deemed free of charge**.
3. All entries must be typewritten/printed/longhand. **Any erasure in the quotation must be countersigned by the bidder/representative**, otherwise quotation will be rejected.
4. The Procuring Entity **may give due preference to goods being offered with green component**.
5. If necessary, the BAC through the TWG, may require an ocular inspection of the venue/place of business/goods being offered.
6. Delivery of Goods / Services is **as indicated** in the next page.
7. Price validity shall be for a period of **120 calendar days from RFQ Opening of the BAC until confirmation of Purchase Order by the winning supplier**.
8. The following documents shall be attached upon submission of quotation, otherwise your quotation will not be accepted, please disregard if already submitted:
  - a. **Updated Mayor's / Business Permit**
  - b. **PhilGEPS Registration Certificate or PhilGEPS Registration Number to be indicated in space below (except for Negotiated Procurement - Emergency Cases, Sec. 53.2, RA 9184 IRR)**
    - o **Income/Business Tax Return (for Small Value Procurement, Direct Contracting above P500K, Emergency Cases above P500K, and Lease of Real Property/Venue).**
9. Where there is discrepancy between: (a) total price per item and unit price for the item as extended or multiplied by the quantity of that item, the unit price shall prevail; (b) stated total price and the actual sum of prices of component items, the lower shall prevail; (c) unit cost in the detailed estimate and unit cost in the bill of quantities, the latter shall prevail.
10. Suppliers/Contractors who **refuse to accept correction of price offer** after Bid Evaluation shall be disqualified.
11. Award of Contract shall be made to the Lowest Calculated Responsive Quotation (LCRQ) that complies to the **technical specifications and the terms and conditions** stated herein.
12. The BAC shall require the bidder with Lowest Calculated Responsive Quotation (LCRQ) to submit the following document prior to issuance of Award / Purchase Order with ABC amounting to P50,000.00 and above.
  - o **Omnibus Sworn Statement (only for Negotiated Procurement - Emergency Cases, Sec. 53.2 and Small Value Procurement Sec. 53.9)**
13. If the Supplier fails to deliver the required goods /services as specified in the Award / Purchase Order, the Procuring Entity may **disqualify bidder from participating future procurement activities to be conducted by DSWD-CAR**.
14. **Liquidated damages equivalent to one tenth of one percent (0.001)** of the value of the goods not delivered within the prescribed delivery period may be imposed per day of delay. The Procuring Entity (PE ) may rescind the contract once the cumulative amount of liquidated damages reaches ten percent (10%) of the amount of the contract, without prejudice to other courses of action and remedies open to it.
15. Further information may be obtained from the Procurement Section with telephone number **(074) 661-0430** local **25025** or email address [bacsec.car@dswd.gov.ph](mailto:bacsec.car@dswd.gov.ph).

REQUEST FOR QUOTATION (REQ)		QUANTITY	UNIT	TOTAL
LOT NO.	DETAILED DESCRIPTION			
1	IMPROVEMENT OF SLOPE PROTECTION AT RSCC PUGUIS, LA TRINIDAD, BENGUET			
	GENERAL REQUIREMENTS	1	Lot	
	EARTHWORKS	1	Lot	
	FORMWORKS AND SCAFFOLDINGS	37.2	sq. m	
	REINFORCING STEEL BAR	1959.06	kgs.	
	STRUCTURAL CONCRETE	17.45	cu.m.	
	CONSTRUCTION SAFETY & HEALTH	1	Lot	
	See the attached plan for specific details			
	<b>OTHER REQUIREMENTS</b>			
	Contractor's Qualifications)			
	a. Contractor shall be competent and experienced in the field of construction with a minimum of two (2) years prior experience.	[ ]	[ ]	
	Contractor's Working Hours			
	a. All normal work for this contract shall be performed during normal daylight hours. Any exceptions will require the written approval of the assigned Project Management Officer.	[ ]	[ ]	
	b. If work is required overnight, the Contractor will be required to furnish safe, proper and sufficient lighting arrangement if necessary.	[ ]	[ ]	
	c. Work may be required on weekends/holidays to avoid interruptions in the Field Office operations.	[ ]	[ ]	
	Contractor's Responsibilities			
	a. Contractor shall submit own construction schedule within ten (10) working days after the receipt of Purchase Order.	[ ]	[ ]	
	b. Contractor / Service provider shall assign project engineer / project architect from the start until completion stage;	[ ]	[ ]	
	c. Contractor / Service provider shall coordinate to the BGMS all the execution of works;	[ ]	[ ]	
	d. Contractor / Service provider shall provide warning signages, project signboard, project log book;	[ ]	[ ]	
	e. Contractor / Service provider shall submit statement of works accomplished and progress photos as requirement of the billing request;	[ ]	[ ]	
	Other Requirements			
	a. All dimensions / level etc. indicated in the drawing plans are to be verified on the site;	[ ]	[ ]	
	b. All materials is subjected for the approval of the end user / BGMS Project Engineer	[ ]	[ ]	
	c. Any discrepancies, either between written dimensions and site dimensions shall be brought to the BGMS office before executing the works	[ ]	[ ]	
	d. Project Duration: 45 calendar days	[ ]	[ ]	
	<b>TOTAL PRICE</b>			

• Award shall be made per:

X Lot basis

Total Quoted Price

Note: **NO GIFT ALLOWED**. Pursuant to RA 6713, otherwise known as the Code of Conduct and Ethical Standards for Public Officials and Employees. The DSWD reserves the right to reject any or all offers at no costs, waive any therein and accept the offer most advantageous to the government.

Sir: After having carefully read and accepted your terms and conditions, I / We submit our bid on the item/s quoted above.

Signature of supplier/representative over printed name:

Name of Firm/Dealer/Contractor:

(This will be the name of the CHEQUE to be issued)

Name and Signature of Canvasser

Address:

Email Address:

Contact Number/s:

PhilGEPS Registration Number:

REPUBLIC OF THE PHILIPPINES  
CORDILLERA ADMINISTRATIVE REGION

Contract Reference Number:  
Name of Project:

IMPROVEMENT OF SLOPE PROTECTION AT RSCC PUGUIS, LA  
TRINIDAD, BENGUET

Location of the Project:  
Standard Form Number SF-INFR-55  
Revised on: August 11, 2004

RSCC Puguis, La Trinidad, Benguet

**BILL OF QUANTITIES**

Columns 1, 2, 3, & 4 are to be filled up by the Procuring Entity			Columns 5 & 6 are to be filled by the bidders		
ITEM NO. 1	ITEM DESCRIPTION 2	UNIT 3	QTY. 4	UNIT PRICE (PESOS) 5	AMOUNT (PESOS) 6
I.	GENERAL REQUIREMENTS	Lot	1.00		
II.	EARTHWORKS	Lot	1.00		
III.	FORMWORKS AND SCAFFOLDINGS	sq.m,	37.20		
IV.	REINFORCING STEEL BAR	kgs.	1,959.06		
V.	STRUCTURAL CONCRETE	cu.m.	17.45		
VI.	CONSTRUCTION SAFETY & HEALTH	lot	1.00		
TOTAL BID PRICE:					
TOTAL AMT. IN WORDS: (in words)					



- 1. REINFORCED CONCRETE:
  - a. THE QUALITY AND DESIGN OF ALL REINFORCED CONCRETE CONSTRUCTION SHALL CONFORM TO THE BUILDING REQUIREMENT FOR REINFORCED CONCRETE AND 1910 - 17.3 AND MANUAL OF STANDARD PRACTICES FOR DETAILING REINFORCED CONCRETE STRUCTURES (ACI 318).
  - b. THE CONTRACTOR SHALL BE RESPONSIBLE FOR THE CONTRACTOR'S DESIGN AND THE QUALITY OF THE CONSTRUCTION OF ALL REINFORCED CONCRETE CONSTRUCTION AT ALL TIMES. THE CONTRACTOR SHALL BE RESPONSIBLE FOR THE CONTRACTOR'S DESIGN AND THE QUALITY OF THE CONSTRUCTION OF ALL REINFORCED CONCRETE CONSTRUCTION AT ALL TIMES.
- 2. REINFORCING STEEL BARS:
  - a. ALL REINFORCING STEEL BARS SHALL BE TYPE AND SIZE AS SPECIFIED ON PLANS.
  - b. REINFORCING STEEL SHALL BE SUPPLIED IN ACCORDANCE WITH THE FOLLOWING TABLE:

GRADE	MINIMUM TENSILE STRENGTH (MPa)	MINIMUM ELONGATION (%)
60	610	10
75	750	10
80	800	10
90	900	10
  - c. REINFORCING STEEL BARS SHALL BE SPLICED IN ACCORDANCE WITH THE FOLLOWING TABLE:

GRADE	MINIMUM LAP LENGTH (mm)
60	300
75	300
80	300
90	300
- 3. CONCRETE MASONRY UNITS:
  - a. FOUNDATION SHALL BE STRENGTHENED TO THE TOP OF THE COURSE ABOVE THE FOUNDATION WALLS TO MATCH THE STRENGTH OF THE FOUNDATION WALLS.
  - b. ALL VERTICAL JOINTS SHALL BE REINFORCED WITH REINFORCING STEEL BARS. THE REINFORCING STEEL BARS SHALL BE SPLICED IN ACCORDANCE WITH THE FOLLOWING TABLE:

GRADE	MINIMUM LAP LENGTH (mm)
60	300
75	300
80	300
90	300
- 4. FOUNDATION:
  - a. ALL FOUNDATIONS SHALL BE REINFORCED WITH REINFORCING STEEL BARS. THE REINFORCING STEEL BARS SHALL BE SPLICED IN ACCORDANCE WITH THE FOLLOWING TABLE:

GRADE	MINIMUM LAP LENGTH (mm)
60	300
75	300
80	300
90	300
- 5. FORMWORKS:
  - a. FORMS OF ALL CONCRETE SHALL BE REINFORCED WITH REINFORCING STEEL BARS. THE REINFORCING STEEL BARS SHALL BE SPLICED IN ACCORDANCE WITH THE FOLLOWING TABLE:

GRADE	MINIMUM LAP LENGTH (mm)
60	300
75	300
80	300
90	300
- 6. SIZES OF AGGREGATES TO BE USED:
  - a. THE FOLLOWING SHALL BE THE MAXIMUM SIZES OF AGGREGATES TO BE USED FOR VARIOUS PURPOSES OF CONCRETE CONSTRUCTION:

GRADE	MAXIMUM SIZE (mm)
60	20
75	20
80	20
90	20
- 7. STRUCTURAL STEEL SECTIONS:

SECTION	GRADE	MINIMUM TENSILE STRENGTH (MPa)	MINIMUM ELONGATION (%)
W8	A36	355	21
W8	A588	485	21
W10	A36	355	21
W10	A588	485	21
W12	A36	355	21
W12	A588	485	21
W14	A36	355	21
W14	A588	485	21
W16	A36	355	21
W16	A588	485	21
W18	A36	355	21
W18	A588	485	21
W20	A36	355	21
W20	A588	485	21
W22	A36	355	21
W22	A588	485	21
W24	A36	355	21
W24	A588	485	21
W26	A36	355	21
W26	A588	485	21
W28	A36	355	21
W28	A588	485	21
W30	A36	355	21
W30	A588	485	21
- 8. REFERENCE TO OTHER DRAWINGS:
  - a. SEE ARCHITECTURAL DRAWINGS FOR MEASUREMENTS OF FLOOR FINISH, DEPRESSIONS IN FLOOR SLABS, OPENINGS ON WALLS AND INTERFERENCE PATTERNS, LOCATIONS OF DOORS, ETC.
  - b. SEE ARCHITECTURAL DRAWINGS FOR MEASUREMENTS OF FLOOR FINISH, DEPRESSIONS IN FLOOR SLABS, OPENINGS ON WALLS AND INTERFERENCE PATTERNS, LOCATIONS OF DOORS, ETC.
- 9. DIMENSIONS:
  - a. IN THE INTERPRETATION OF THESE DRAWINGS, INVOLVED DIMENSIONS SHALL GOVERN AND DISTANCES ON SHEETS OF DIMENSIONS SHALL BE BROUGHT TO THE ATTENTION OF THE ARCHITECT, ENGINEER OR PROFESSIONAL ENGINEER FOR CORRECTION BEFORE PROCEEDING WITH THE WORK.
- 10. DISCREPANCIES:
  - a. STRUCTURAL DIMENSIONS SHALL NOT BE SCALED FOR USE IN CONSTRUCTION.
  - b. THE CONTRACTOR SHALL NOTIFY THE ARCHITECT IMMEDIATELY UPON DETECTION OF ANY DISCREPANCY.
- 11. SHOP DRAWINGS:
  - a. THE CONTRACTOR SHALL SUBMIT TO THE ARCHITECT FOR APPROVAL SHOP DRAWINGS FOR ALL STRUCTURAL STEEL AND CONCRETE REINFORCEMENT DETAILS. THE SHOP DRAWINGS SHALL BE SUBMITTED TO THE ARCHITECT AT LEAST 14 DAYS BEFORE THE START OF CONSTRUCTION.
  - b. THE CONTRACTOR SHALL BE RESPONSIBLE FOR THE SHOP DRAWINGS AND THE QUALITY OF THE CONSTRUCTION OF ALL SHOP DRAWINGS.

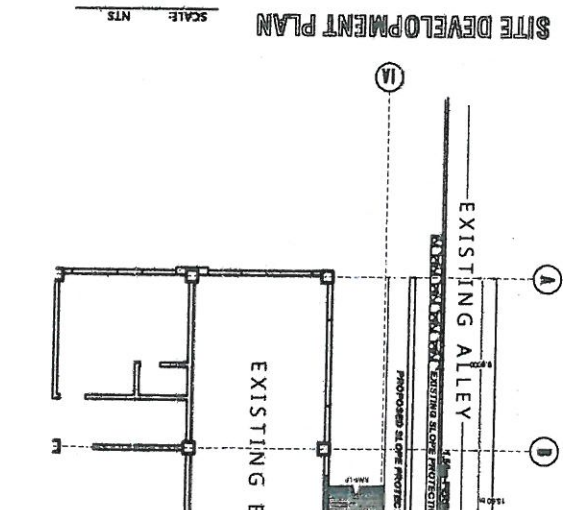
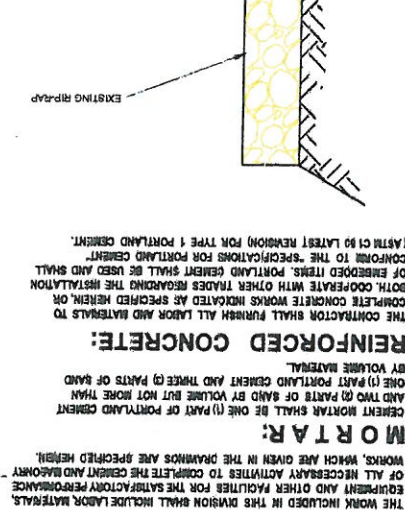

**FOUNDATION:**  
THE WORK INCLUDED IN THIS DIVISION COMPRISES THE FURNISHING OF ALL LABOR MATERIALS AND OTHER FACILITIES AND THE SATISFACTORY PERFORMANCE OF ALL WORK NECESSARY TO COMPLETE THE PREPARATION FOR FOUNDATION AND FOOTINGS SHOWN ON THE DRAWING AND SPECIFIED HEREIN.

**CONCRETE WORKS:**  
THE CONTRACTOR SHALL BE RESPONSIBLE FOR THE CONTRACTOR'S DESIGN AND THE QUALITY OF THE CONSTRUCTION OF ALL REINFORCED CONCRETE CONSTRUCTION AT ALL TIMES.

**CONCRETE CURING:**  
AFTER FINISHING SURFACES CURING SHALL BE DONE BY KEEPING THE CONCRETE MOIST FOR AT LEAST ONE (1) WEEK AFTER POURING. FLOOR AND VERTICAL SURFACES MAY BE SPRAYED WITH AN APPROVED PREPARATION TO RETARD EVAPORATING WATER OR MOST PROVIDED. SPRAYING IS NOT OPERATIONAL BECAUSE OF SUBSEQUENT FRICTION. PREPARATION TO RETARD EVAPORATING WATER OR MOST PROVIDED SHALL BE APPLIED TO ALL SURFACES AS SOON AS CONCRETE HAS ATTAINED ITS INITIAL SET.

**REPAIR OF CONCRETE:**  
REPAIR OF CONCRETE IMPERFECTION SHALL BE COMPLETED WITHIN TWENTY-FOUR (24) HOURS AFTER REMOVAL OF FORMS. FINE SHALL BE NEATLY REMOVED FROM EXPOSED SURFACES.

**CEMENT AND MASONRY WORKS:**  
THE WORK INCLUDED IN THIS DIVISION SHALL INCLUDE LABOR MATERIALS, EQUIPMENT AND OTHER FACILITIES FOR THE SATISFACTORY PERFORMANCE OF ALL NECESSARY ACTIVITIES TO COMPLETE THE CONCRETE AND MASONRY WORKS WHICH ARE GIVEN IN THE DRAWINGS AND SPECIFIED HEREIN.

**MORTAR:**  
CEMENT MORTAR SHALL BE ONE (1) PART OF PORTLAND CEMENT AND TWO (2) PARTS OF SAND BY VOLUME BUT NOT MORE THAN ONE (1) PART OF PORTLAND CEMENT AND THREE (3) PARTS OF SAND BY VOLUME BATTERED.

**REINFORCED CONCRETE:**  
THE CONTRACTOR SHALL FURNISH ALL LABOR AND MATERIALS TO COMPLETE THE REINFORCED CONCRETE WORKS INDICATED AS SPECIFIED HEREIN. OR BOTH APPROVED PORTLAND CEMENT AND OTHER FACILITIES FOR THE SATISFACTORY PERFORMANCE OF ALL NECESSARY ACTIVITIES TO COMPLETE THE CONCRETE AND MASONRY WORKS WHICH ARE GIVEN IN THE DRAWINGS AND SPECIFIED HEREIN.

FOOTING PLAN VIEW  
SCALE: NTS

SITE DEVELOPMENT PLAN  
SCALE: NTS

DEPARTMENT OF SOCIAL WELFARE AND DEVELOPMENT - CAR  
PROJECT NAME: IMPROVEMENT OF SLOPE PROTECTION AT NSCC PUGUIS, LA TRINIDAD, BENGUET  
LOCATION: NSCC PUGUIS, LA TRINIDAD, BENGUET  
SHEET CONTENT: AS SHOWN  
APPROVED BY: ANNE B. GARCIA, CSO II, Regional Director  
CHECKED BY: JESSIE F. CHISUM, OIC Chief Administrative Division  
PREPARED BY: JOHN PHILLIP DAMAS, ENGINEER-LEADS  
PROJECT/TA NO.:  
DATE SUBMITTED:  
DRAWING STATUS:  
DATE: DESCRIPTION/REMARKS BY